

For Lease

Far North I-25 Office Suites

SEAGULL OFFICE PARK



GREAT VALUE FOR FAR NORTH I-25

6100 Seagull St. & 5801 Osuna Rd. NE | Albuquerque, NM 87109

SEQ San Mateo Blvd. Academy Rd. NE



AVAILABLE
±1,334 SF



LEASE RATE
\$17.00/SF Full Service

- Great location near I-25 & San Mateo Blvd. between Academy and Osuna Roads
- Close to restaurants, shopping and other amenities
- Easy access to I-25
- Plenty of on-site parking
- 3:1,000 parking ratio
- IDO Zoning: NR-C

NAISunVista

got space™

Martha Carpenter
martha@sunvista.com
505 228 0154

Lisa Mercer
lisa@sunvista.com
505 235 8503

For Lease

FAR NORTH I-25 OFFICE SUITES | SEAGULL OFFICE PARK

6100 Seagull St. & 5801 Osuna Rd. NE | Albuquerque, NM 87109



LOCATION

Demographics	1 mile	3 mile	5 mile
Total Population	12,010	99,374	244,888
Average HH Income	\$78,518	\$94,449	\$99,557
Daytime Employment	15,872	99,391	177,910

2023 Forecasted by Esri

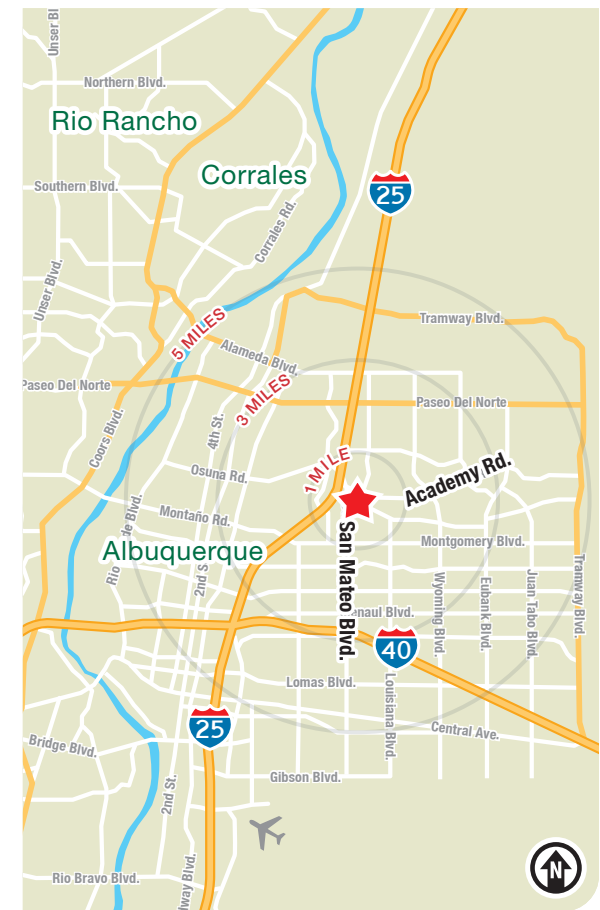

NAISunVista

505 878 0001 | sunvista.com |
2424 Louisiana Blvd. NE | Suite 100 | Albuquerque, NM 87110

Martha Carpenter
martha@sunvista.com
505 228 0154

Lisa Mercer
lisa@sunvista.com
505 235 8503

For Lease

FAR NORTH I-25 OFFICE SUITES | SEAGULL OFFICE PARK

6100 Seagull St. & 5801 Osuna Rd. NE | Albuquerque, NM 87109



For Lease

FAR NORTH I-25 OFFICE SUITES | SEAGULL OFFICE PARK

6100 Seagull St. & 5801 Osuna Rd. NE | Albuquerque, NM 87109

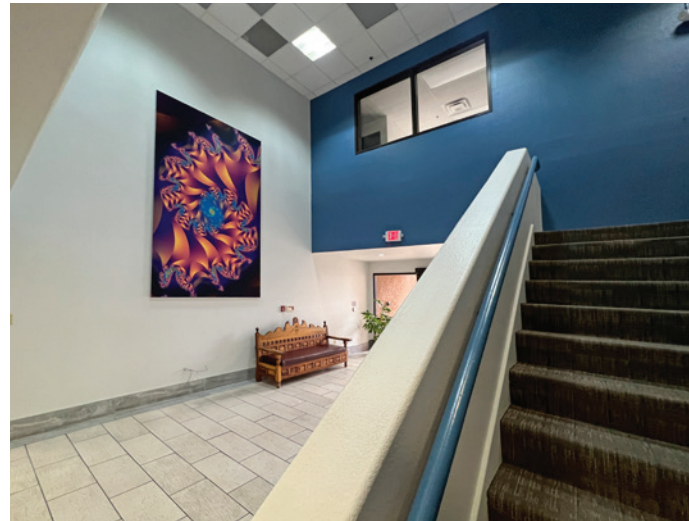

NAISunVista

The information contained is believed reliable. While we do not doubt the accuracy, we have not verified it and make no guarantee, warranty or representation about it. It is your responsibility to independently confirm its accuracy and completeness. Any projection, opinion, assumption or estimated uses are for example only and do not represent the current or future performance of the property. The value of this transaction to you depends on many factors which should be evaluated by your tax, financial, and legal counsel. You and your counsel should conduct a careful independent investigation of the property to determine that it is suitable to your needs.

Martha Carpenter
martha@sunvista.com
505 228 0154

Lisa Mercer
lisa@sunvista.com
505 235 8503