

Centrally-Located Office Near the Big-I

OPEN-OFFICE SUITE WITH SECURED PARKING

For Lease



1111 Menaul Blvd. NE | Bldg. B | Albuquerque, NM 87107

NEC Menaul Blvd. & Broadbent Pkwy. NE



AVAILABLE

Suite A:
±5,815 SF



LEASE RATE

\$14.50/SF
Modified Gross

- Open-office architecture with two large work areas
- One break area, one set of restrooms and shower
- Gated/secured parking area for up to 11 vehicles
- Shaded outdoor area
- Windows and skylights throughout
- Fire suppression system

NASunVista

got space™

Shelly Branscom, CCIM
shelly@sunvista.com
505 414 2669

For Lease

CENTRALLY-LOCATED OFFICE NEAR THE BIG-I

1111 Menaul Blvd. NE | Bldg. B | Albuquerque, NM 87107



LOCATION

Demographics	1 mile	3 mile	5 mile
Total Population	5,969	95,364	257,928
Average HH Income	\$64,207	\$82,286	\$80,157
Daytime Employment	12,175	120,066	229,227

2024 Forecasted by Esri

HUB Zone [MORE INFO](#)

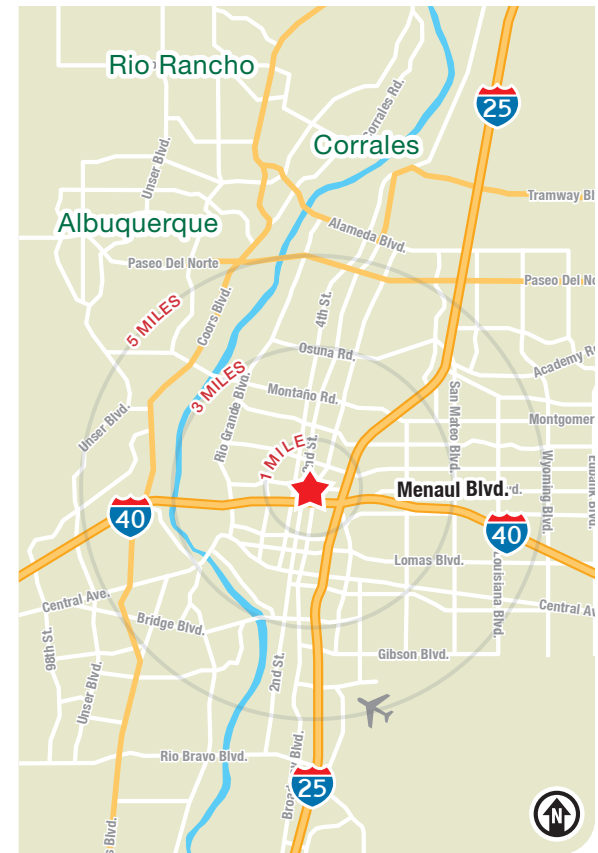

For Lease

CENTRALLY-LOCATED OFFICE NEAR THE BIG-I

1111 Menaul Blvd. NE | Bldg. B | Albuquerque, NM 87107

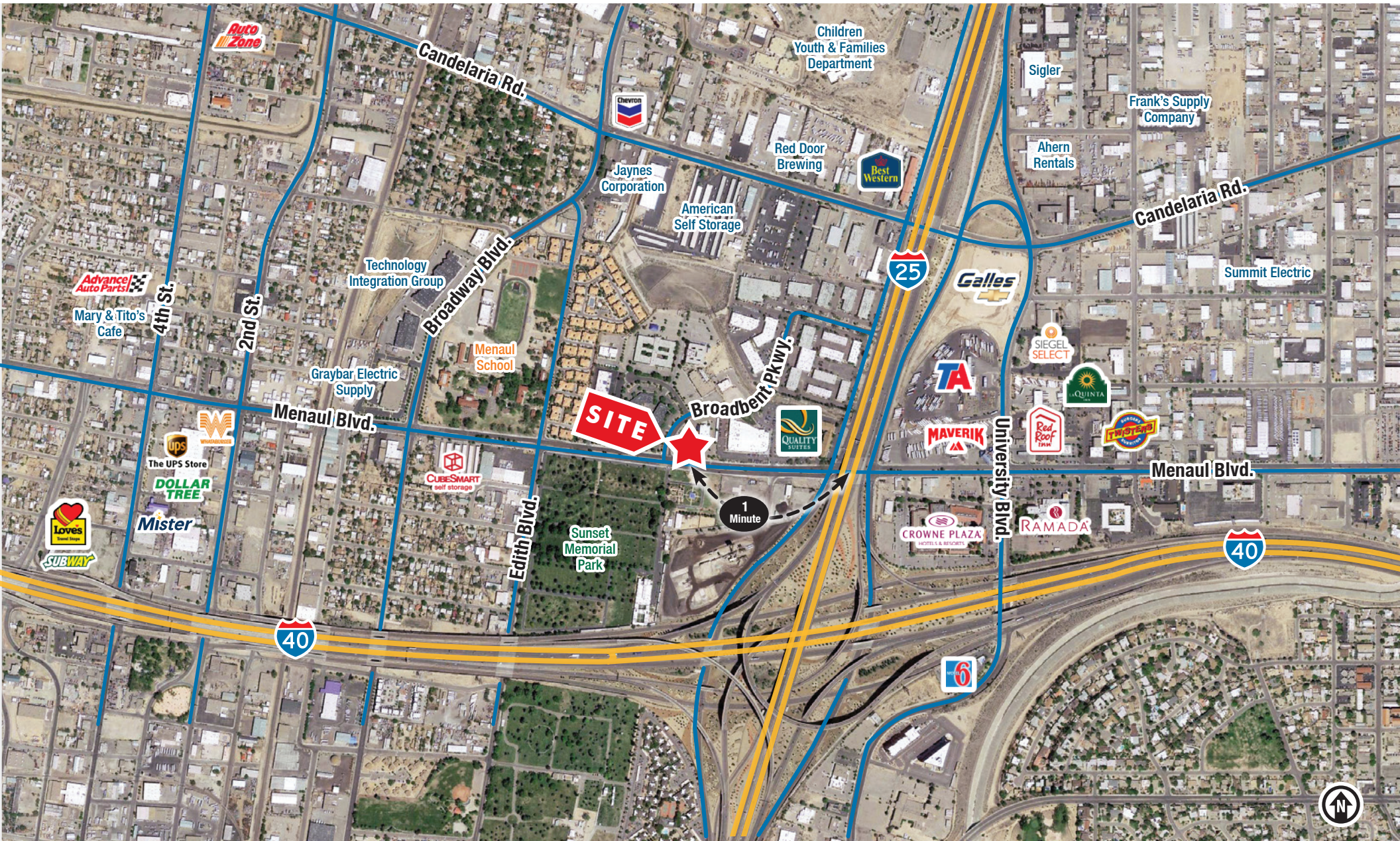

For Lease

CENTRALLY-LOCATED OFFICE NEAR THE BIG-I

1111 Menaul Blvd. NE | Bldg. B | Albuquerque, NM 87107



NAISunVista

505 878 0001 | sunvista.com    

2424 Louisiana Blvd. NE | Suite 100 | Albuquerque, NM 87110

Shelly Branscom, CCIM

shelly@sunvista.com

505 414 2669

For Lease

CENTRALLY-LOCATED OFFICE NEAR THE BIG-I

1111 Menaul Blvd. NE | Bldg. B | Albuquerque, NM 87107

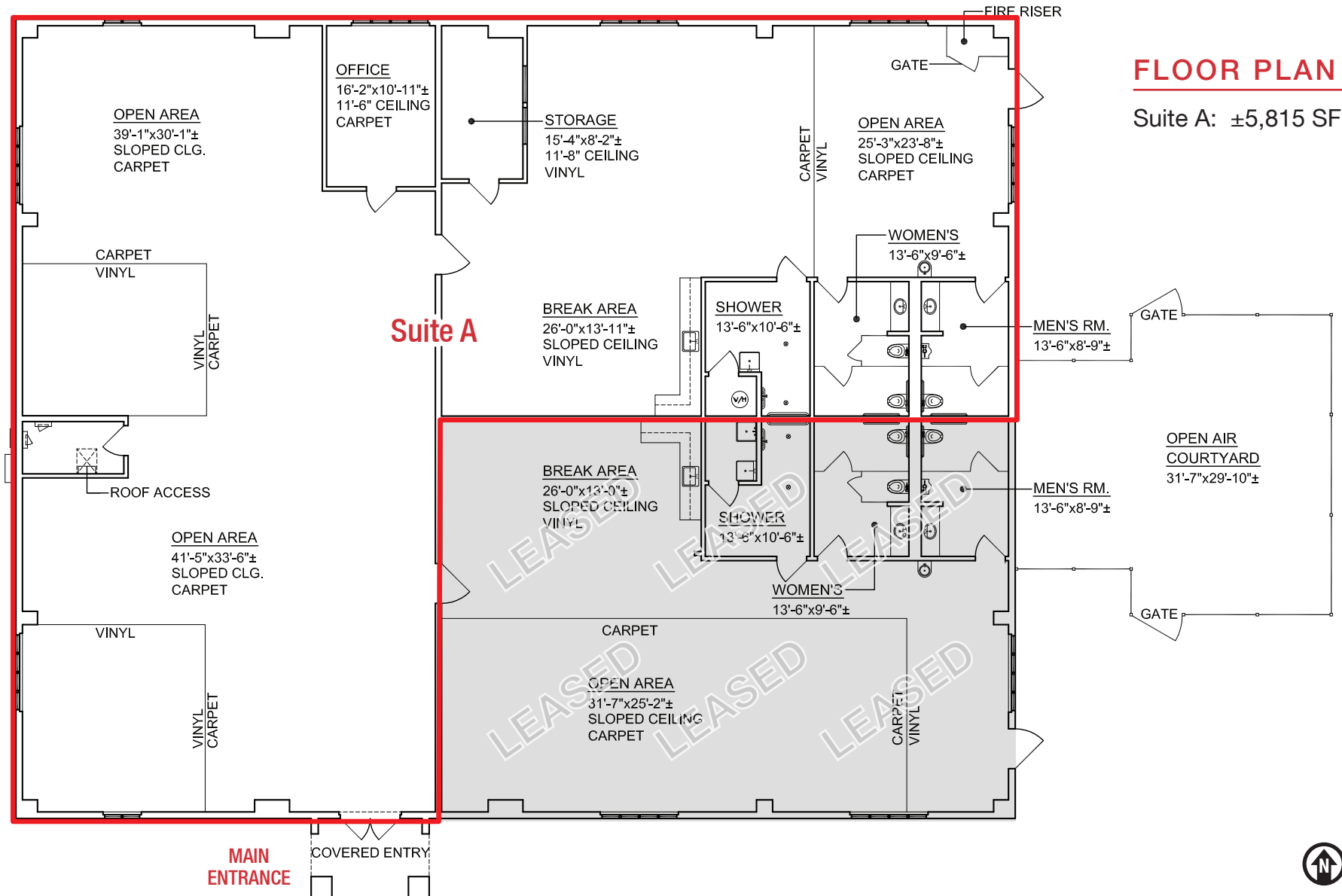

Albuquerque

TRADE AREA ANALYSIS

ALBUQUERQUE | NEW MEXICO

Located near the geographic center of New Mexico at the intersection of I-25 and I-40 and resting at the foot of the Sandia Mountains, Albuquerque is the state's most populous city and one of the most livable in the U.S. The city serves as a major transportation and shipping hub for the Southwest, with BNSF Railway, air cargo from Albuquerque International Airport (Sunport), and a commuter train running from Belen to Santa Fe. Albuquerque is home to the International Balloon Fiesta, the world's largest gathering of hot-air balloons. A talented workforce, a business-friendly environment, a community rooted in history and a high quality of life make Albuquerque hard to beat.

ALBUQUERQUE BY THE NUMBERS (ESRI 2024 Demographics)

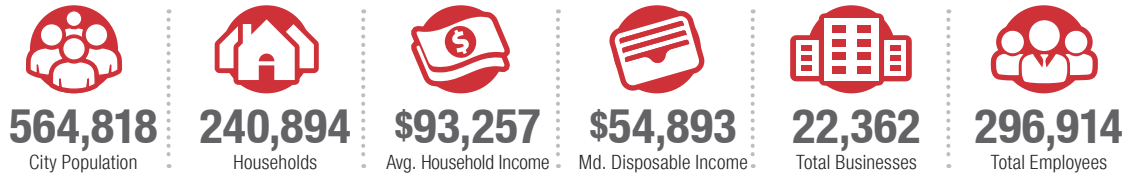

In the News

Ranked 6th in America's favorite cities list - *Travel + Leisure*
Ranks among America's best cities for global trade - *Global Trade Magazine*
The 5th most cost-friendly city to do business in the U.S. - *KPMG*

TOP 8 REASONS TO CHOOSE ALBUQUERQUE

- Low-risk location
- Skilled workforce
- Business incentives
- The metro area communities
- Quality of life
- Cost of living
- Innovation central
- On the cutting edge of technology



926,835
Albuquerque Metro Population



The Largest
City in the State



HEALTHCARE

Albuquerque is the center of health care excellence in New Mexico. UNM is a nationally-recognized Class 1 research institution. There are more than 2,000 hospital beds in the metro area.



EDUCATION | SKILLED WORKFORCE

Albuquerque is top in nation for cities with the most college graduates – more than 70,000 college students reside in metro area. The area also has one of the largest number of PhD's per capita in the nation.



COMPETITIVE BUSINESS CLIMATE

Low energy costs, low property taxes, affordable real estate, low cost of living, a qualified/productive workforce, aggressive incentives and efficient market access make Albuquerque an attractive choice.