

For Lease

Northeast Heights Retail Shop Space

EXCELLENT VISIBILITY & SIGNAGE OPPORTUNITY

1016 Juan Tabo Blvd. NE | Albuquerque, NM 87112

NEQ Juan Tabo & Lomas Blvds. NE



AVAILABLE
±1,200 SF



LEASE RATE
\$14.00/SF + Utilities
(\$1,400/Mo.)

- Dense retail trade area
- Heavy residential population
- 92 common-area parking spaces
- Pylon signage available
- Highly visible to over 32,500 CPD
- IDO Zoning: MX-L

NAI SunVista

got space™

Ethan Melvin
ethan@sunvista.com
505 235 9347

Alexis Lovato
alexis@sunvista.com
505 639 6433

Riley McKee
riley@sunvista.com
505 379 1549

For Lease

NORTHEAST HEIGHTS RETAIL SHOP SPACE

1016 Juan Tabo Blvd. NE | Albuquerque, NM 87112



NAI SunVista

505 878 0001 | sunvista.com    
2424 Louisiana Blvd. NE | Suite 100 | Albuquerque, NM 87110

Ethan Melvin
ethan@sunvista.com
505 235 9347

Alexis Lovato
alexis@sunvista.com
505 639 6433

Riley McKee
riley@sunvista.com
505 379 1549

For Lease

NORTHEAST HEIGHTS RETAIL SHOP SPACE

1016 Juan Tabo Blvd. NE | Albuquerque, NM 87112

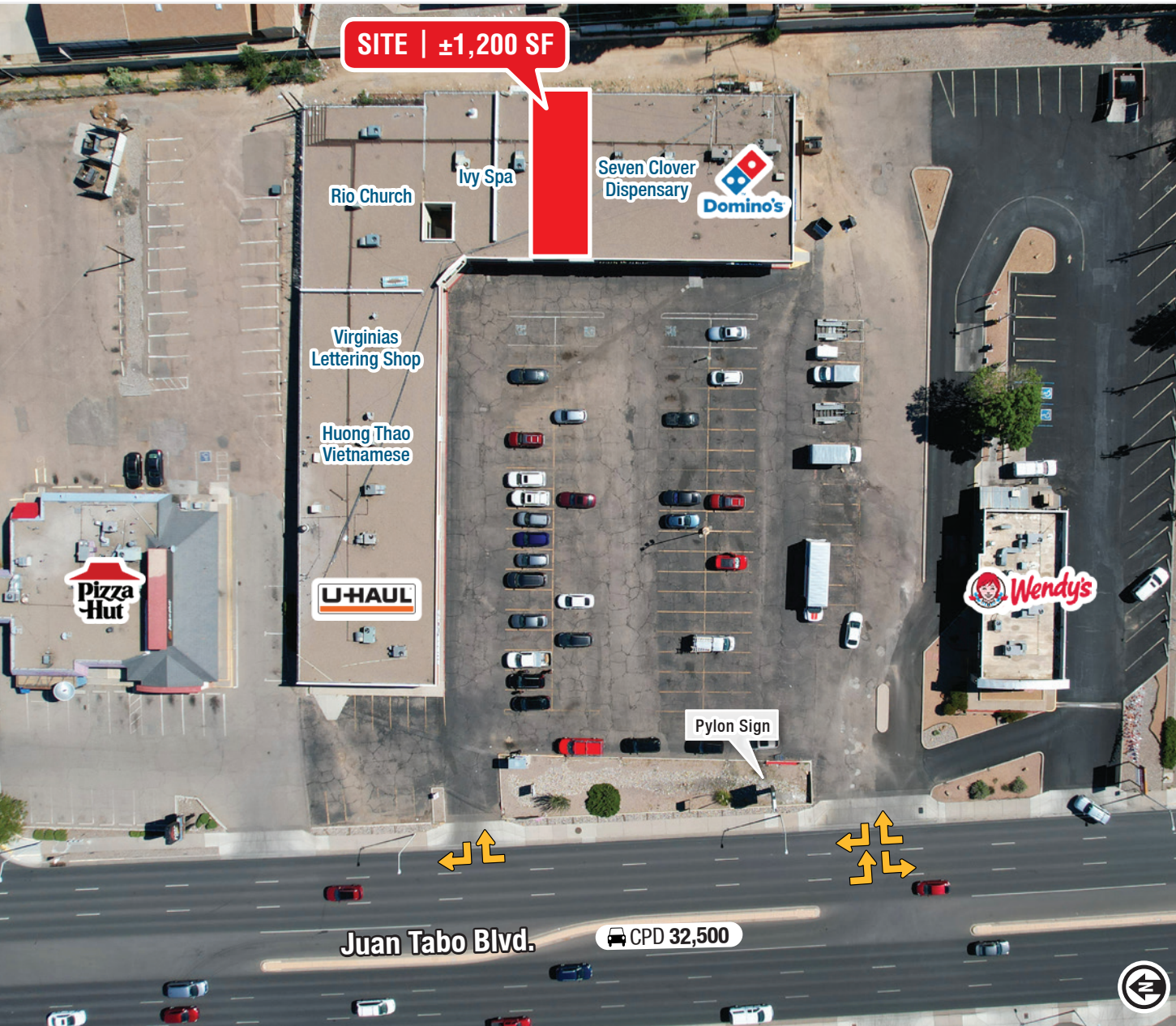

LOCATION

Demographics	1 mile	3 mile	5 mile
Total Population	19,087	119,041	225,937
Average HH Income	\$79,746	\$85,734	\$93,346
Daytime Employment	4,311	42,691	92,247

2023 Forecasted by Esri

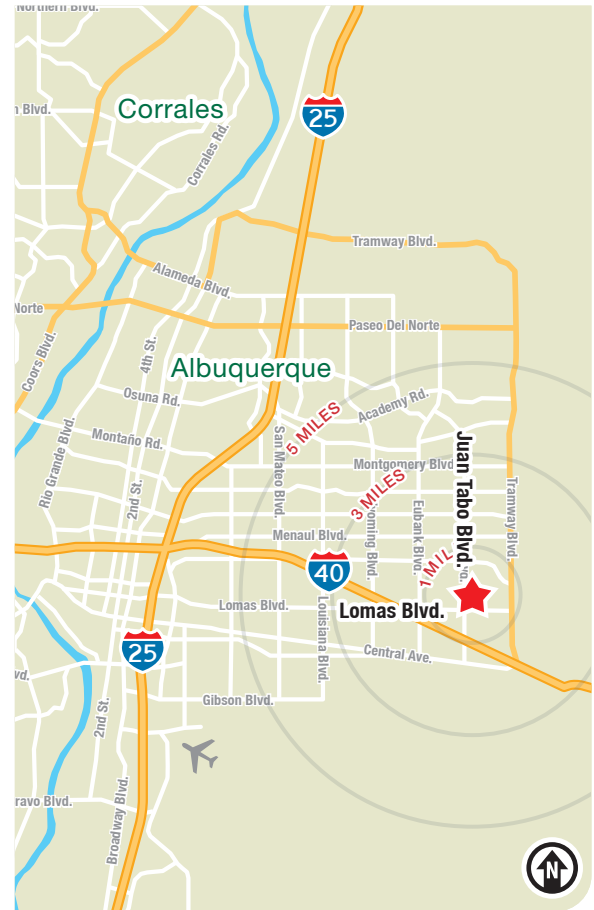

505 878 0001 | sunvista.com
 2424 Louisiana Blvd. NE | Suite 100 | Albuquerque, NM 87110

Ethan Melvin
 ethan@sunvista.com
 505 235 9347

Alexis Lovato
 alexis@sunvista.com
 505 639 6433

Riley McKee
 riley@sunvista.com
 505 379 1549

For Lease

NORTHEAST HEIGHTS RETAIL SHOP SPACE

1016 Juan Tabo Blvd. NE | Albuquerque, NM 87112

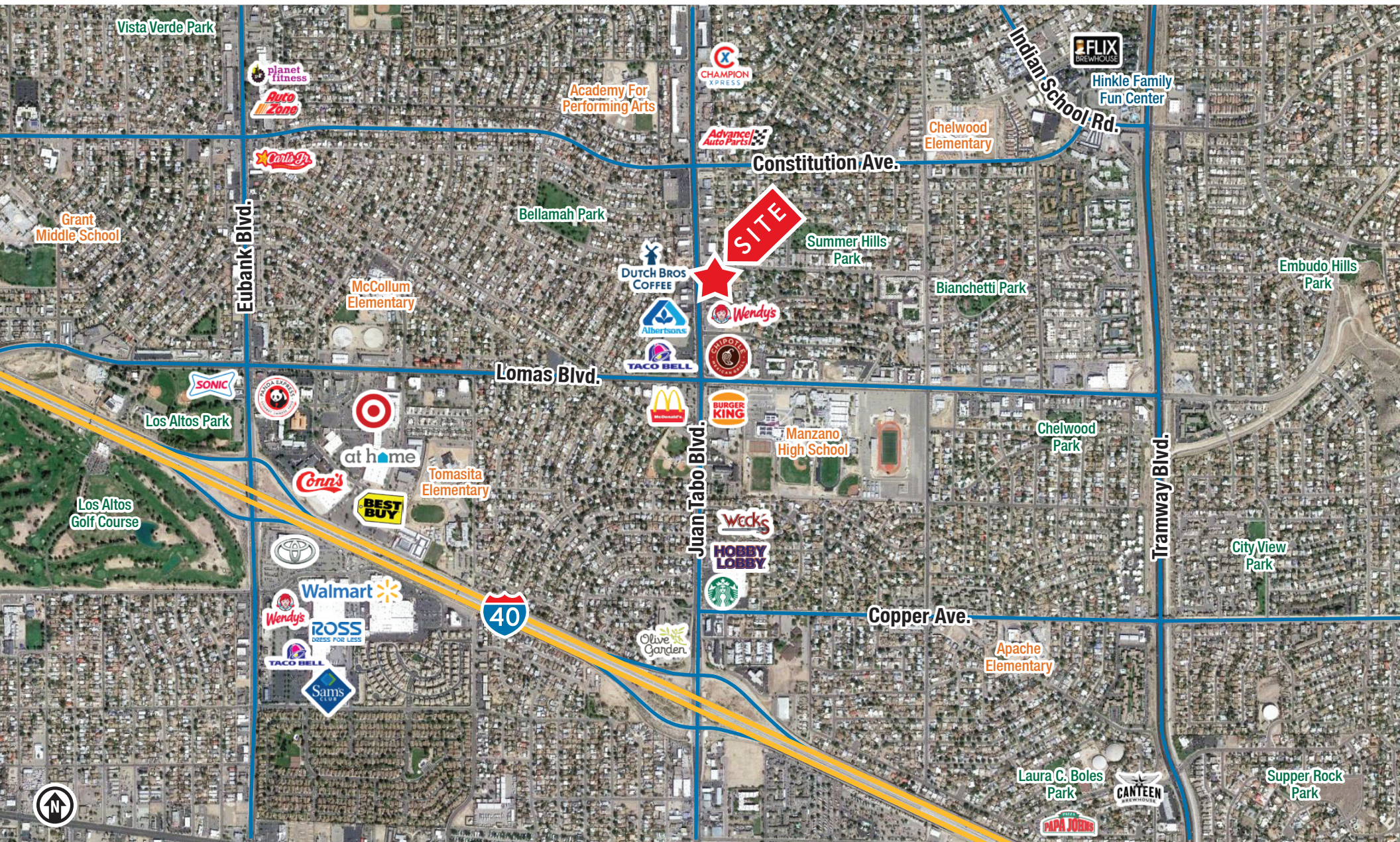

505 878 0001 | sunvista.com    
2424 Louisiana Blvd. NE | Suite 100 | Albuquerque, NM 87110

Ethan Melvin
ethan@sunvista.com
505 235 9347

Alexis Lovato
alexis@sunvista.com
505 639 6433

Riley McKee
riley@sunvista.com
505 379 1549

Albuquerque

TRADE AREA ANALYSIS

ALBUQUERQUE | NEW MEXICO

Located near the geographic center of New Mexico at the intersection of I-25 and I-40 and resting at the foot of the Sandia Mountains, Albuquerque is the state's most populous city and one of the most livable in the U.S. The city serves as a major transportation and shipping hub for the Southwest, with BNSF Railway, air cargo from Albuquerque International Airport (Sunport), and a commuter train running from Belen to Santa Fe. Albuquerque is home to the International Balloon Fiesta, the world's largest gathering of hot-air balloons. A talented workforce, a business-friendly environment, a community rooted in history and a high quality of life make Albuquerque hard to beat.

ALBUQUERQUE BY THE NUMBERS (ESRI 2023 Demographics)



566,387
City Population



241,133
Households



\$92,972
Avg. Household Income



\$52,179
Md. Disposable Income



21,085
Total Businesses



291,840
Total Employees



923,076
Albuquerque Metro Population



The Largest
City in the State



In the News

Ranked 6th in America's favorite cities list - *Travel + Leisure*
Ranks among America's best cities for global trade - *Global Trade Magazine*
The 5th most cost-friendly city to do business in the U.S. - *KPMG*

TOP 8 REASONS TO CHOOSE ALBUQUERQUE

- Low-risk location
- Skilled workforce
- Business incentives
- The metro area communities
- Quality of life
- Cost of living
- Innovation central
- On the cutting edge of technology



HEALTHCARE

Albuquerque is the center of health care excellence in New Mexico. UNM is a nationally-recognized Class 1 research institution. There are more than 2,000 hospital beds in the metro area.



EDUCATION | SKILLED WORKFORCE

Albuquerque is top in nation for cities with the most college graduates – more than 70,000 college students reside in metro area. The area also has one of the largest number of PhD's per capita in the nation.



COMPETITIVE BUSINESS CLIMATE

Low energy costs, low property taxes, affordable real estate, low cost of living, a qualified/productive workforce, aggressive incentives and efficient market access make Albuquerque an attractive choice.