

For Lease

# Freestanding Santa Fe Retail Box

GREAT VISIBILITY WITH CERRILLOS RD. FRONTAGE



41,600 CARS PER DAY!

3242 Cerrillos Rd. | Santa Fe, NM 87507

*SWQ Cerrillos Rd. & Camino Consuelo*



#### AVAILABLE

Building: ±2,700 SF  
Land: ±0.46 Acres



#### LEASE RATE

See Advisors

- In the heart of the Santa Fe retail corridor
- Existing restaurant infrastructure with 20' hood
- Located just off a signalized intersection
- Ample parking with access on Cerrillos Rd.
- Pylon and façade signage available
- Zoning: C-2

**NA**SunVista

got space™

**Randall Parish**  
randall@sunvista.com  
505 338 4110

**John Algermissen, CCIM**  
johna@sunvista.com  
505 998 5734

# For Lease

## FREESTANDING SANTA FE RETAIL BOX

3242 Cerrillos Rd. | Santa Fe, NM 87507



**McDonald's**  
627K Visits  
4/23 to 3/24

**Walmart** ✨  
2.4M Visits  
4/23 to 3/24

**Walgreens**  
627K Visits  
4/23 to 3/24

**Blakes LOTABURGER**  
150.5K Visits  
4/23 to 3/24

**SITE**  
• Building: ±2,700 SF  
• Land: ±0.46 Acres

# For Lease

## FREESTANDING SANTA FE RETAIL BOX

3242 Cerrillos Rd. | Santa Fe, NM 87507

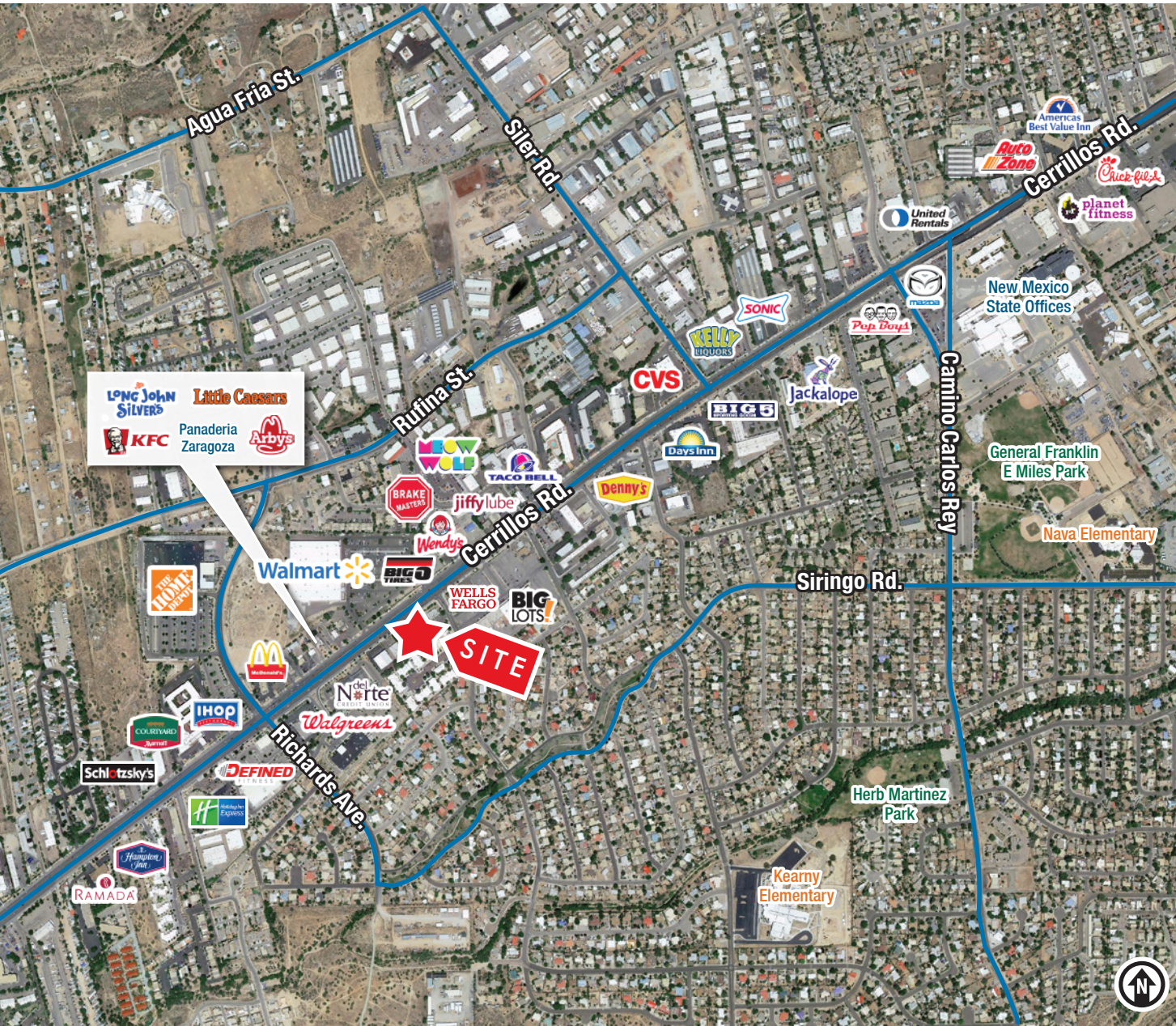

### LOCATION

Demographics	1 mile	3 mile	5 mile
Total Population	10,058	62,566	98,859
Average HH Income	\$72,306	\$90,149	\$102,842
Daytime Employment	7,315	42,588	78,458

2023 Forecasted by Esri

### HUB Zone [MORE INFO](#)

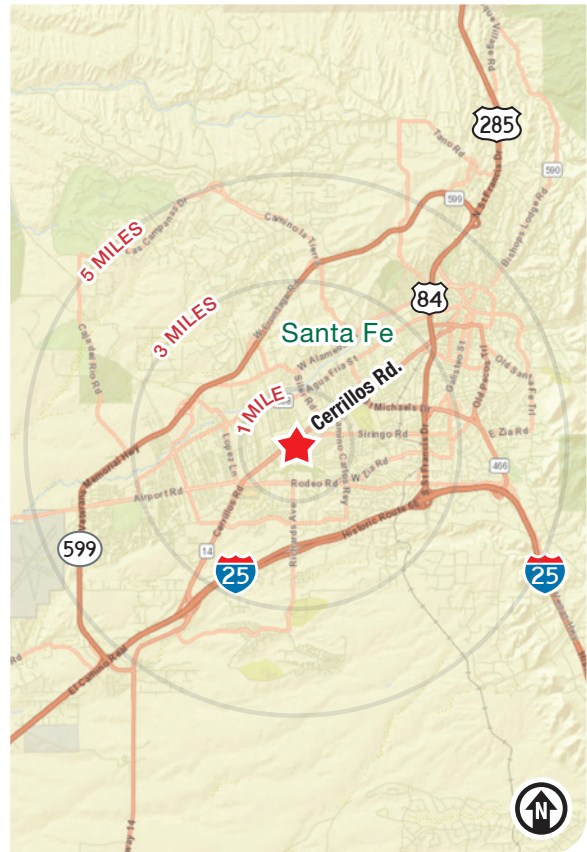

For Lease

## FREESTANDING SANTA FE RETAIL BOX

3242 Cerrillos Rd. | Santa Fe, NM 87507

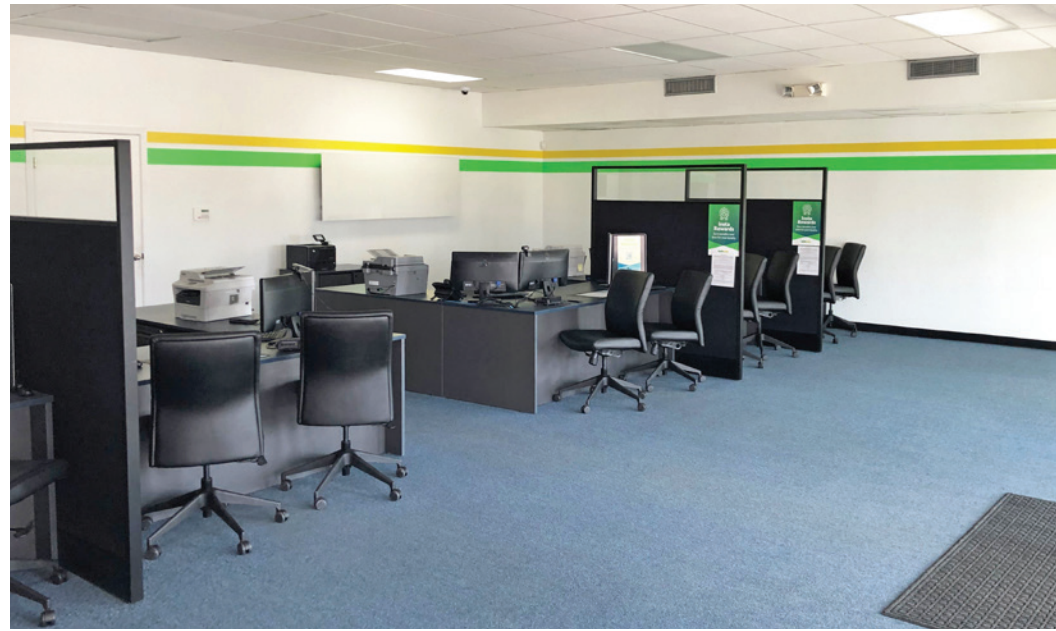

505 878 0001 | [sunvista.com](http://sunvista.com)    

2424 Louisiana Blvd. NE | Suite 100 | Albuquerque, NM 87110

Randall Parish  
[randall@sunvista.com](mailto:randall@sunvista.com)  
505 338 4110

John Algermissen, CCIM  
[johna@sunvista.com](mailto:johna@sunvista.com)  
505 998 5734

## SANTA FE | THE CITY DIFFERENT

The oldest capital city in the United States and the oldest city in New Mexico, Santa Fe is well-known as a center for arts that reflect the multicultural character of the region. Tourism is a major element of the Santa Fe economy, with visitors attracted year-round by the mild climate, outdoor activities and cultural events that the area offers. Most tourist activity takes place in the historic downtown, especially on and around Santa Fe Plaza, a one-block square adjacent to the Palace of the Governors, the original seat of New Mexico's territorial government during the time of Spanish colonization. Other areas include Canyon Road and "Museum Hill", the site of the major art museums of the city as well as the Santa Fe International Folk Art Market. Seasonal activities, such as skiing at nearby Santa Fe Ski Basin in the winter and hiking are also a draw for tourists.



New Mexico  
**State  
Capitol**



### SANTA FE BY THE NUMBERS (Metropolitan Statistical Area, ESRI 2023 Demographics)



**157,756**  
MSA Population



**70,027**  
Households



**\$108,696**  
Avg. Household Income



**\$57,762**  
Md. Disposable Income



**8,099**  
Total Businesses



**91,336**  
Total Employees

**FOUNDED IN 1608, SANTA FE IS THE OLDEST STATE CAPITAL IN THE UNITED STATES**

### SANTA FE ACCOLADES

- One of The Best Small Cities in the U.S. *Conde Nast Traveler 2022*
- Star Award Winners List *Forbes Travel Guide 2022*
- Best Places to Buy a Vacation Rental *House Digest 2022*
- One of America's Greatest Ski Towns *Thrillist 2022*
- Top 15 Cities in the U.S. *Travel + Leisure 2022*
- 10 Best Cities in the World for Art Lovers *Travel + Leisure 2022*
- World's Greatest Places *Time Magazine 2021*
- One of the 21 Best Places to Retire *Retire Better Now 2021*
- Top 100 Best Places to Live *Livability 2021*



### A TOURIST DESTINATION

Santa Fe is the **3rd-Largest Art Market in the United States** after New York and Los Angeles.



A half-mile stretch of Santa Fe's Canyon Road has **more than 100** galleries, boutiques and restaurants "making it the world's densest concentration of art galleries." *FourSeasons.com*