

For Lease

Recently-Updated Stand-Alone Building

CENTRALLY LOCATED BETWEEN NOB HILL AND UPTOWN



5400 Lomas Blvd. NE | Albuquerque, NM 87108

SEQ San Mateo Blvd. & Lomas Blvd. NE



AVAILABLE
±2,376 SF



LEASE RATE
\$13.00/SF Modified Gross
(\$2,574/Mo.)

- Updated interior
- Flexible use for office or retail
- Excellent visibility with frontage on Lomas Blvd.

NA SunVista

got space™

Danaë Fernández
danae@sunvista.com
505 604 8766

Micah Gray
micah@sunvista.com
505 338 9878

For Lease

RECENTLY-UPDATED STAND-ALONE BUILDING

5400 Lomas Blvd. NE | Albuquerque, NM 87108

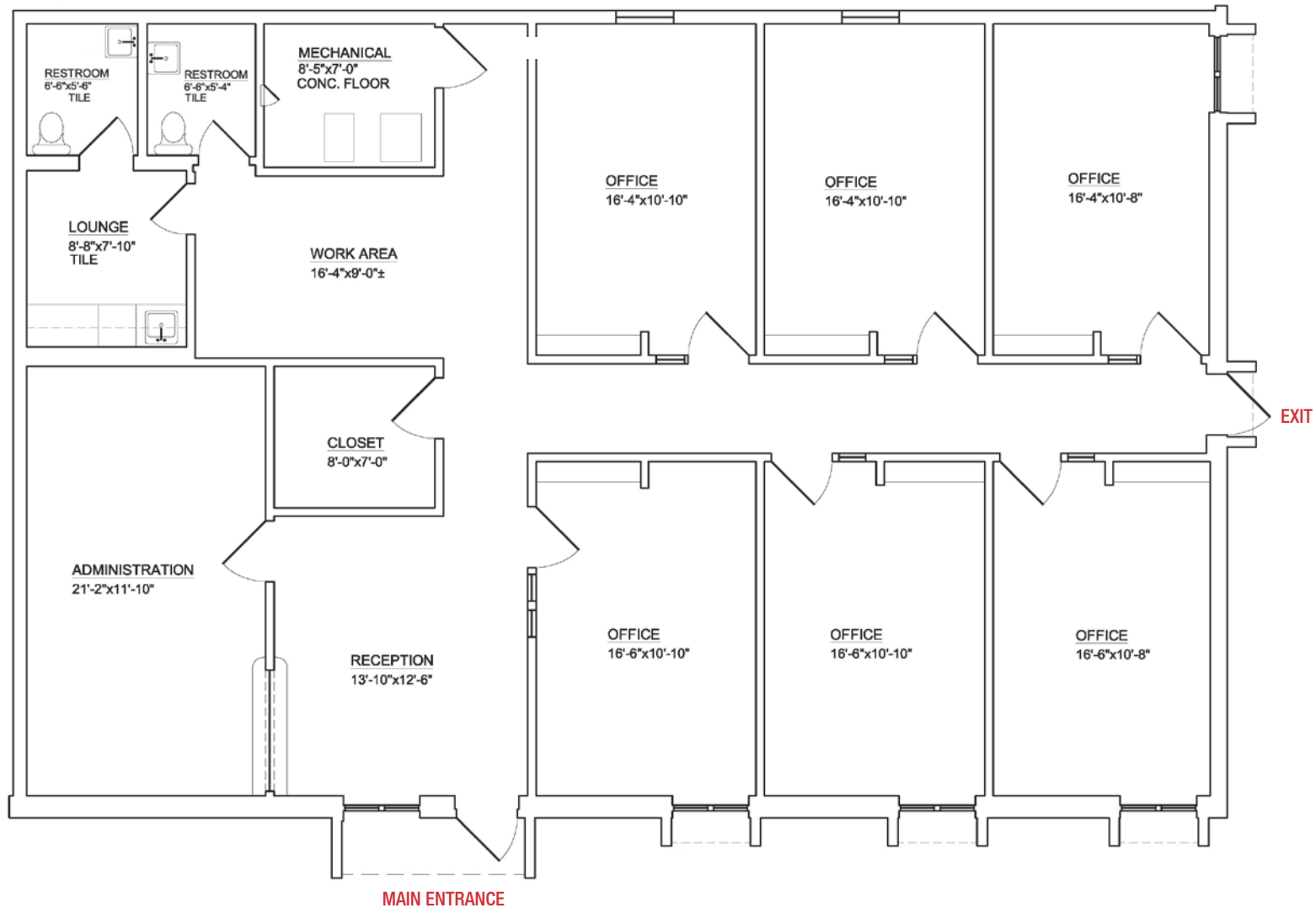

FLOOR PLAN

± 2,376 SF

For Lease

RECENTLY-UPDATED STAND-ALONE BUILDING

5400 Lomas Blvd. NE | Albuquerque, NM 87108



SITE

AVAILABLE

Building: ±2,367 SF
Land: ±0.21 Acres

IDO ZONING

▪ [MX-M](#)

HIGHLIGHTS

- 6 offices
- Reception area
- Break room
- 2 bathrooms
- 12 parking spots for a 5:1,000 ratio
- Large pylon signage along Lomas Blvd. for maximum exposure
- Great visibility with 26,900 cars per day
- Flexible use for office or retail
- Only 3 minutes to I-40 and just 5 minutes to Nob Hill

For Lease

RECENTLY-UPDATED STAND-ALONE BUILDING

5400 Lomas Blvd. NE | Albuquerque, NM 87108



505 878 0001 | sunvista.com    
2424 Louisiana Blvd. NE | Suite 100 | Albuquerque, NM 87110

Danaë Fernández
danae@sunvista.com
505 604 8766

Micah Gray
micah@sunvista.com
505 338 9878

For Lease

RECENTLY-UPDATED STAND-ALONE BUILDING

5400 Lomas Blvd. NE | Albuquerque, NM 87108

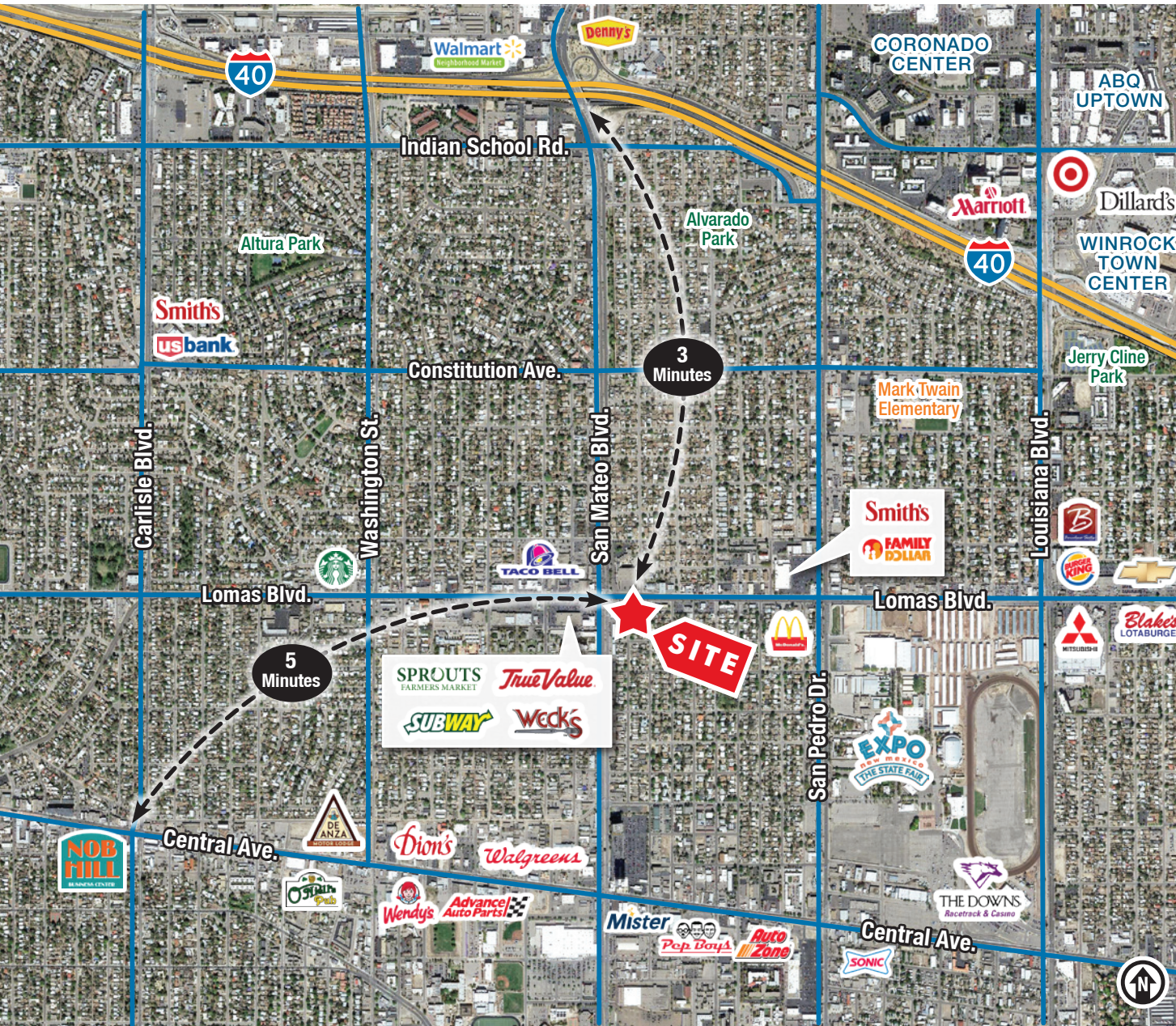

LOCATION

Demographics	1 mile	3 mile	5 mile
Total Population	13,860	116,926	263,470
Average HH Income	\$89,804	\$73,800	\$77,957
Daytime Employment	8,682	97,434	227,794

2024 Forecasted by Esri

